

FMRC(M)6000

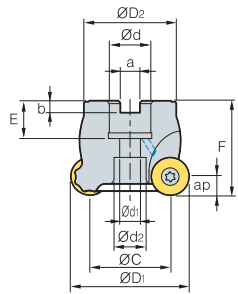

Fig. 1

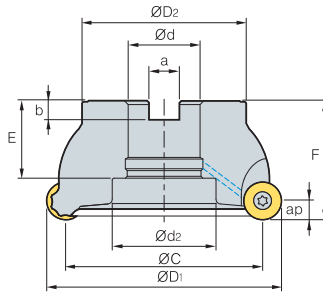

Fig. 2

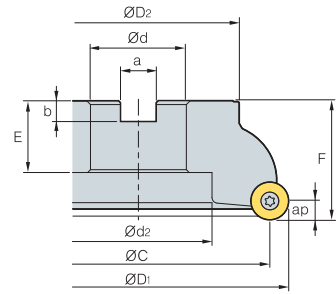
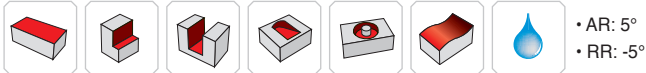

Fig. 3



• AR: 5°
• RR: -5°

(mm)

Designation		ØD	ØC	ØD ₂	Ød	a	b	E	F	Ød ₁	Ød ₂	ap		Fig.	
FMRCM	6063HRD	3	63	43	49	22	10.4	6.3	20	50	11	17	10.0	0.5	1
	6063HRD-M	4	63	43	49	22	10.4	6.3	20	50	11	17	10.0	0.5	1
FMRC (FMRCM)	6080HRD	4	80	60	57	25.4 (27)	9.5 (12.4)	6 (7.0)	25 (22)	50	14	20	10.0	0.8	1
	6080HRD-M	5	80	60	57	25.4 (27)	9.5 (12.4)	6 (7.0)	25 (22)	50	14	20	10.0	0.8	1
	6100HRD	5	100	80	67	31.75 (32)	12.7 (14.4)	8 (8)	32 (28)	63	18	26	10.0	1.6	1
	6100HRD-M	6	100	80	67	31.75 (32)	12.7 (14.4)	8 (8)	32 (28)	63	18	26	10.0	1.6	1
	6125HRD	6	125	105	87	38.1 (40)	15.9 (16.4)	10 (9)	41 (29)	63	- (22)	55 (32)	10.0	2.7 (2.9)	2 (1)
	6125HRD-M	7	125	105	87	38.1 (40)	15.9 (16.4)	10 (9)	41 (29)	63	- (22)	55 (32)	10.0	2.7 (2.9)	2 (1)
6160RD	7	160	140	107	50.8 (40)	19 (16.4)	11 (9)	38 (35)	63	-	78	10.0	4.4	3	
6160RD-M	8	160	140	107	50.8 (40)	19 (16.4)	11 (9)	38 (35)	63	-	78	10.0	4.4	3	

() Metric size

Available inserts

RDHW-E,F,S RDKT-MM



Designation	Cermet		Coated											Uncoated		page		
	CN2000	CN30	NCM325	NC5330	NCM535	NCM545	PC2505	PC2010	PC3600	PC3700	PC6510	PC9530	PC9540	PC5300	PC5400		ST30A	H01
RDHW	2006MOE																	E15
	2006MOF																	
	2006MOS																	
RDKT	2006M0-MM									●								

Available arbors

Designation	Ød	NC arbors
FMRCM	6063HRD	BT□□-FMC22-□□
	6063HRD-M	
FMRC (FMRCM)	6080HRD	BT□□-FMA/FMB25.4-□□
	6080HRD-M	BT□□-FMB/FMC27-□□
6100HRD	31.75	BT□□-FMA31.75-□□
6100HRD-M	32	BT□□-FMC32-□□
6125HRD	38.1	BT□□-FMA/FMB38.1-□□
6125HRD-M	40	BT□□-FMB/FMC40-□□
6160RD	50.8	BT□□-FMA50.8-□□
6160RD-M	40	BT□□-FMB/FMC40-□□

Parts

Specification		
Ø63~Ø160	FTGA0515-P	TW20-100

Available inserts E15, E16

Available arbors and bolt E400~E402